

Let's see the correct way of concealing water piping inside the walls.

01

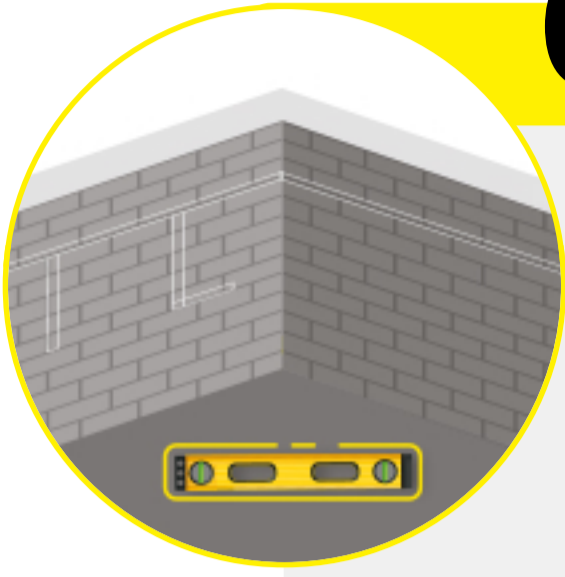

First of all, mark the points for taps, showers, wash basins and the way for the pipes connecting to them on walls. You can use spirit level for this. The drainage flow and potable water flow should not overlap each other.

02

After that, cut the marked area with the disc blade. Take note that, the depth of the cutting should be 4-6 mm more than the size of the pipes and one important thing... concrete beam or column should never be cut.

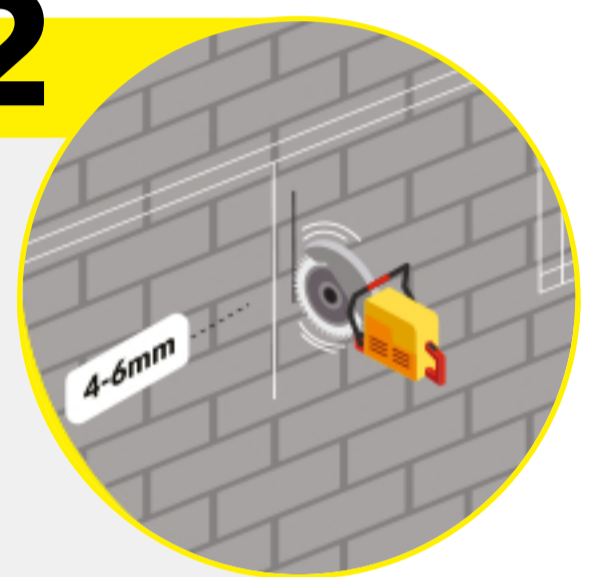

03

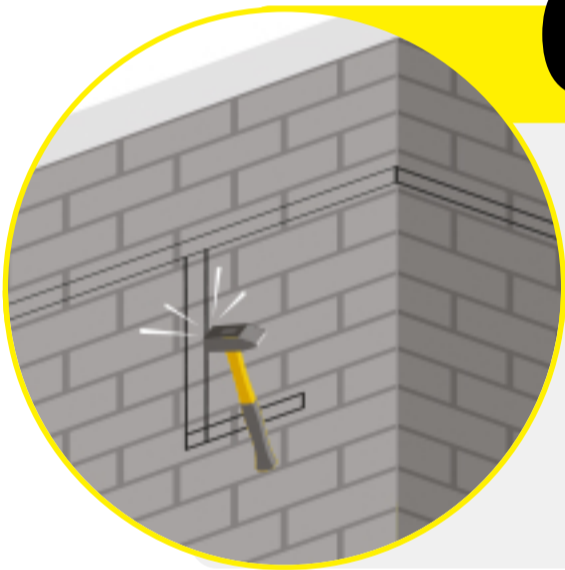

For making grooves, cut the portion between the two lines with the help of a shovel; if the wall is load bearing, do not cut it at one time.

04

Fit the pipes with the help of the nails in the grooves.

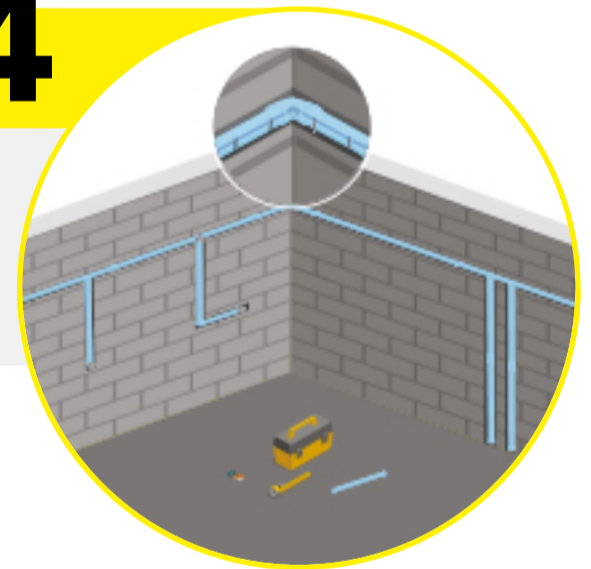

05

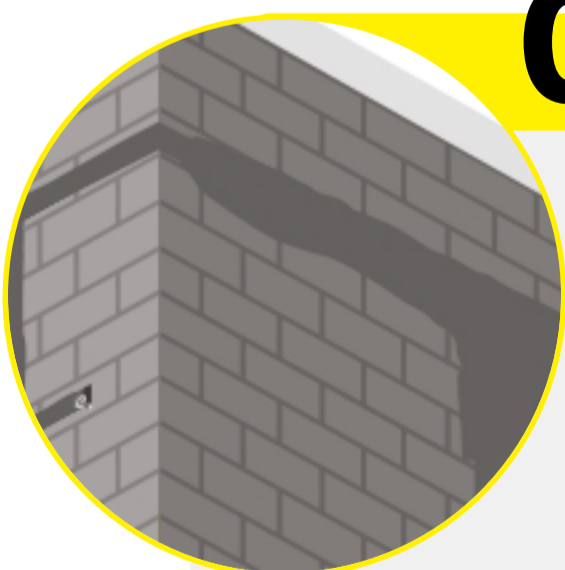

Fill the gap between the pipes and the wall by applying a mortar of cement and soil. To avoid cracks in the future, use a steel mesh, fix the mesh on the groove and fix and fill it with the mortar and nail.



For more information on home-builing, click here.