

In this checklist, find some important terms and their meanings related to construction:

01

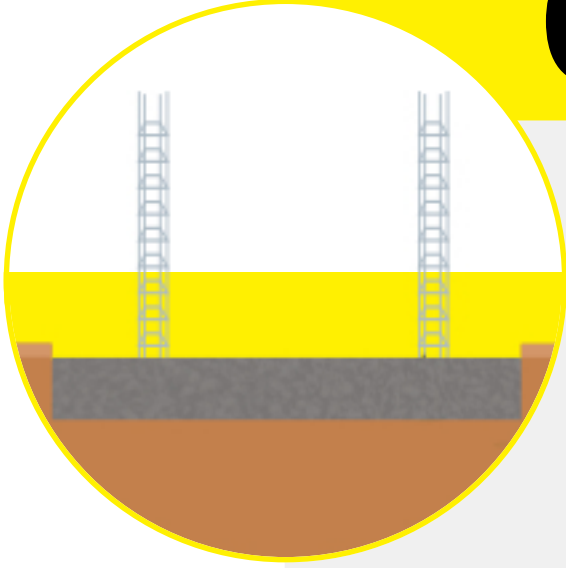

Foundation:

The foundation transfers all the load of the building to the land, therefore, decide the depth and width of the foundation as per requirement and as advised by the engineer.

02

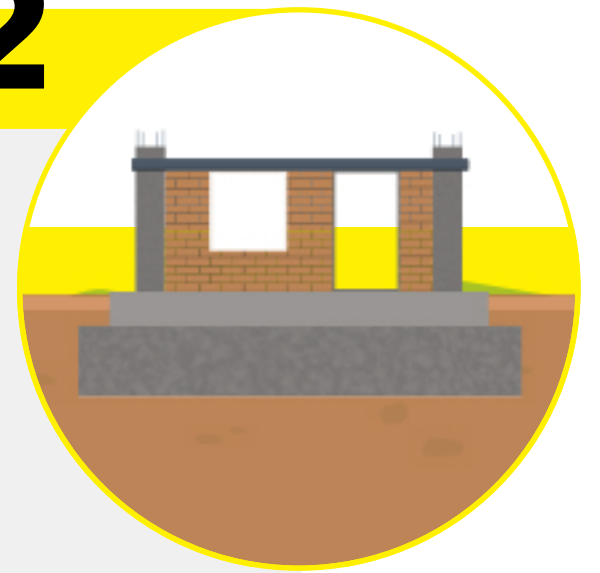

Plinth beam:

The plinth beam acts as a strong joint between the wall and foundation. This is an RCC beam, which helps foundation lift the load of the house.

03

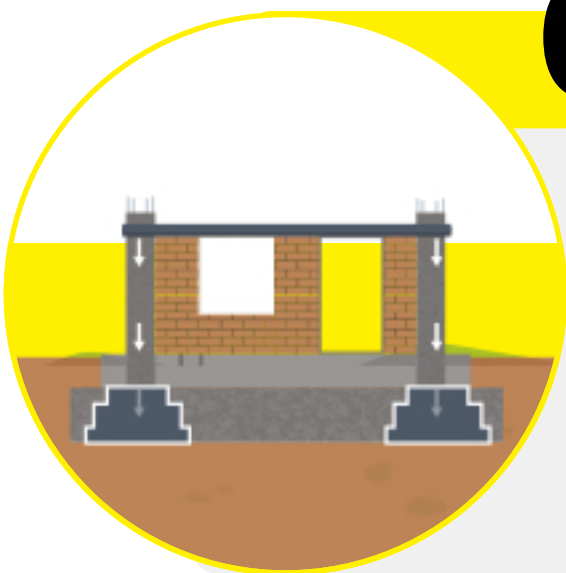

Footing:

Footing transfers the load of one footing column to big area, which increases the capacity of the structure.

04

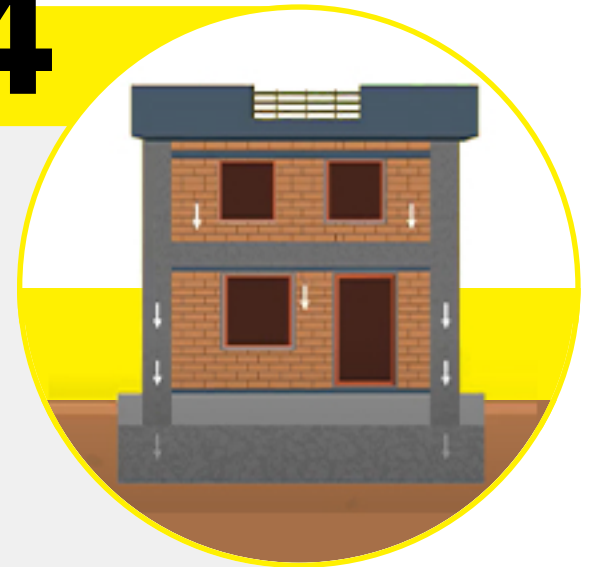

Columns and Beams:

The load coming from the slab is transferred to the columns by the beams. Columns transfer the entire load to the foundation. All these things provide strength to the house in their own ways; the construction of the same should be done with alertness.



For more information on home-builing, [click here](#).